

Finish type: DIN 6094 31.5 Standard

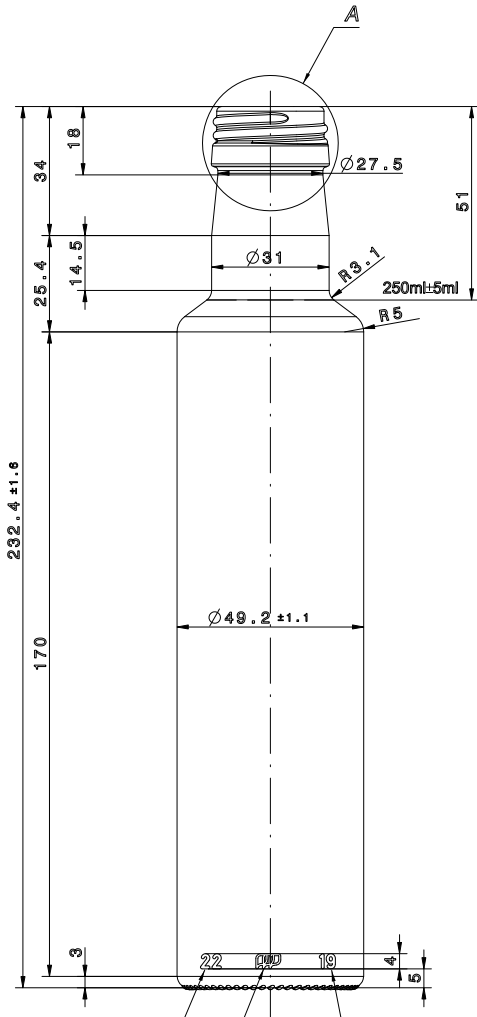

Front view
Scale: 1:1

Broj kalupe, 0.3 mm izbočeno
Mould no., 0.3 mm high

Tvornički znak, 0.3 mm izbočeno
Trade mark, 0.3 mm high

Godina proizvodnje, 0.3 mm izbočeno
Year of production, 0.3 mm high

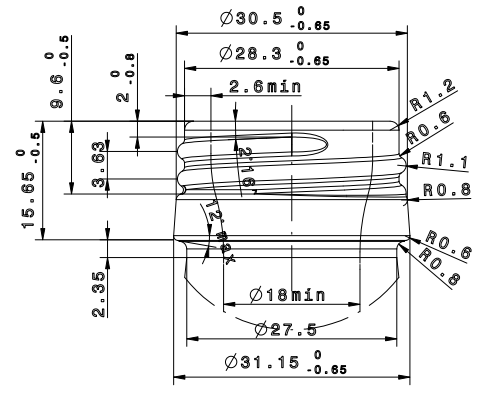

Detail A
Scale: 2:1

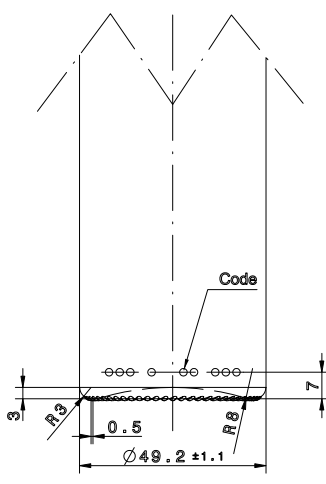

Rear view
Scale: 1:1

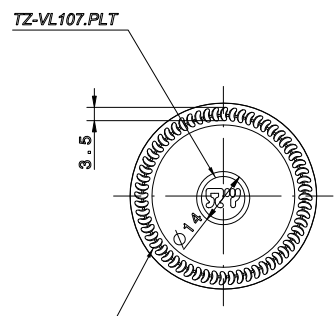

Bottom view
Scale: 1:1

60 rečki, 0.5 mm izbočeno
60 knuris, 0.5 mm high

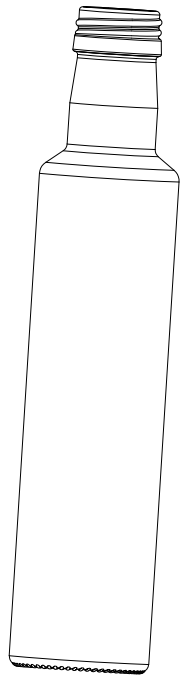

Isometric view
Scale: 3:4

		ARTIKAL			
Kom.	Naziv dijela	Poz.	Materijal	Dimenzija	
	Datum	Ime i prezime			
	18.09.18.	Zeljec T.			
	Crtao	Zeljec T.			
	18.09.18.	KRKLEC			
	Naziv: DORICA 250ml				
	Sadržaj: 250ml (do vrha 275 ±8ml)				
b	Changed heel engraving	07.11.18.	Zeljec T.	Težina: 250g	
a	Added bottom engraving	25.10.18.	Zeljec T.	Proces: puhanu - puhanu (BB)	Kupac: MODERN COMPANY
Index	Revizija	Datum	Izmijenio	Mjerski: 1:1	Broj nacrt: 00-00

